



# CALCULOS

Información del proyecto	Sistema de coordenadas
Nombre: D:\Usuarios\Jesus\Documentos\Trimble Business Center\260217- Pablo Neruda 140-142 Madrid.vce	Nombre: World wide/UTM
Tamaño: 686 KB	Datum: ETRS89
Modificado/a: 17/02/2026 15:01:05 (UTC:1)	Zona: 30 North
Zona horaria: Hora estándar romance	Geoide: Egm08
Número de referencia:	Datum vertical:
Descripción:	

### Detalles adicionales del sistema de coordenadas

Configuraciones ajuste local			
Latitud del proyecto:	?	Factor de escala del terreno:	1
Longitud del proyecto:	?	D.eje falso este:	0,000 m
Altura del proyecto:	600,000 m	D.eje falso norte:	0,000 m

## Lista de vectores

Nivel de confianza de la precisión: 95%									
ID vector	ID del punto de origen	Al ID punto	Hora de inicio	Duración	$\Delta X$ (Metro)	$\Delta Y$ (Metro)	$\Delta Z$ (Metro)	Acimut	Dist. elip. (Metro)
<a href="#">V1</a>	<a href="#">PRS689046862025</a>	<a href="#">1000</a>	17/02/2026 11:12:26	00:00:20	1937,589	1998,623	-2183,062	143° 11'53"	3536,972
<a href="#">V2</a>	<a href="#">PRS689046862025</a>	<a href="#">2000</a>	17/02/2026 11:14:36	00:00:18	1924,066	1999,821	-2165,685	142° 58'44"	3519,555

Fecha:17/02/2026 15:01:27	Proyecto:D:\Usuarios\Jesus\Documentos\Trimble Business Center\260217- Pablo Neruda 140-142 Madrid.vce	Trimble Business Center
---------------------------	---	-------------------------



# COORDENADAS

Información del proyecto		Sistema de coordenadas	
Nombre:	D:\Usuarios\Jesus\Documentos\Trimble Business Center\260217- Pablo Neruda 140-142 Madrid.vce	Nombre:	World wide/UTM
Tamaño:	686 KB	Datum:	ETRS89
Modificado/a:	17/02/2026 15:01:05 (UTC:1)	Zona:	30 North
Zona horaria:	Hora estándar romance	Geoide:	Egm08
Número de referencia:		Datum vertical:	
Descripción:			

#### Detalles adicionales del sistema de coordenadas

Configuraciones ajuste local			
Latitud del proyecto:	?	Factor de escala del terreno:	1
Longitud del proyecto:	?	D.eje falso norte:	0,000
Altura del proyecto:	600,000	D.eje falso este:	0,000

#### Lista de puntos

ID	Este (Metro)	Norte (Metro)	Elevación (Metro)	Código de característica
1	443848,245	4470321,516	632,852	alc 1.5x1.8
2	443848,927	4470322,557	632,890	bomb
3	443849,383	4470322,644	632,905	ag
4	443845,957	4470318,046	632,493	b
5	443847,687	4470318,004	632,557	b
6	443848,819	4470320,093	632,646	b
7	443855,584	4470321,516	633,042	alc 1.6x1.4
8	443858,976	4470320,682	633,099	tel
9	443860,454	4470322,081	633,156	al
10	443860,260	4470320,882	633,145	f
11	443863,364	4470319,916	633,064	b
12	443862,484	4470321,109	633,208	alc 1x1.1
13	443869,703	4470321,024	633,433	alc 1x1.1
14	443876,930	4470320,918	633,653	alc 1x1.1
15	443880,063	4470321,541	633,782	al
16	443880,092	4470320,594	633,774	f
17	443884,123	4470320,863	633,907	alc
18	443887,445	4470319,654	633,851	b
19	443887,968	4470321,961	634,032	san
20	443891,366	4470320,793	634,143	alc
21	443898,784	4470320,849	634,401	alc

22	443896,755	4470319,553	634,163	b
23	443896,758	4470319,549	634,162	b
24	443901,738	4470321,248	634,567	al
25	443901,660	4470320,273	634,527	f
26	443905,961	4470320,584	634,655	alc
27	443912,113	4470319,396	634,684	b
28	443911,375	4470328,510	634,812	b
29	443906,425	4470327,405	634,891	alc 1x1
30	443904,772	4470328,612	634,728	imb
31	443904,313	4470329,157	634,876	san
32	443904,899	4470339,205	634,987	b
33	443907,070	4470342,371	635,090	a
34	443907,190	4470349,613	635,338	a
35	443905,018	4470351,987	635,374	b
36	443904,622	4470355,633	635,656	san imb
37	443907,149	4470356,854	635,596	a
38	443903,472	4470360,793	635,828	al
39	443904,341	4470360,600	635,806	f
40	443907,216	4470363,971	635,766	a
41	443905,238	4470372,221	636,007	b
42	443907,439	4470371,436	636,016	a
43	443907,261	4470378,778	636,260	a
44	443904,871	4470382,280	636,487	san imb
45	443905,338	4470380,095	636,246	b
46	443907,654	4470385,759	636,462	a
47	443906,360	4470389,891	636,608	san
48	443905,474	4470392,443	636,734	b
49	443912,858	4470392,384	637,059	b
50	443908,563	4470394,014	637,013	alc
51	443907,030	4470393,945	636,949	alc
52	443906,240	4470393,975	636,901	tel
53	443904,902	4470393,949	636,843	tel
54	443906,232	4470395,147	636,910	tel
55	443903,996	4470396,219	636,785	al
56	443902,342	4470401,854	636,746	b
57	443892,808	4470402,353	636,406	san imb
58	443887,733	4470402,000	636,078	b
59	443876,550	4470402,104	635,553	b
60	443866,364	4470402,254	635,089	b

61	443861,597	4470402,700	634,939	san imb
62	443849,455	4470402,435	634,304	b
63	443850,139	4470397,536	634,488	m
64	443862,958	4470397,536	635,054	b
65	443874,659	4470397,423	635,612	b
66	443887,605	4470397,256	636,207	b
67	443901,887	4470397,098	636,694	b
68	443901,846	4470392,785	636,759	b
69	443902,543	4470392,759	636,773	b
70	443902,445	4470382,855	636,568	b
71	443902,329	4470371,367	636,209	b
72	443902,205	4470358,824	635,810	b
73	443902,052	4470346,442	635,443	b
74	443901,948	4470336,320	635,137	b
75	443901,811	4470324,506	634,729	b
76	443888,708	4470324,603	634,143	b
77	443876,701	4470324,743	633,744	b
78	443862,747	4470324,872	633,285	b
79	443849,231	4470325,029	632,961	m
80	443849,318	4470333,067	633,087	m.34
81	443849,401	4470342,056	633,173	m.34
82	443849,538	4470351,483	633,309	m.34
83	443849,688	4470361,828	633,361	m.34
84	443849,778	4470371,976	633,527	m.34
85	443849,925	4470381,747	633,761	m.34
86	443850,077	4470391,535	634,048	m.34
87	443855,874	4470393,749	634,615	r
88	443861,721	4470393,827	635,111	r
89	443867,482	4470393,794	635,239	r
90	443874,070	4470393,759	635,516	r
91	443880,215	4470393,746	635,875	r
92	443886,460	4470393,662	636,102	r
93	443892,733	4470393,762	636,406	r
94	443899,925	4470393,494	636,648	r
95	443900,826	4470387,731	636,528	r
96	443894,068	4470386,875	636,480	r
97	443887,774	4470387,072	636,072	r
98	443881,673	4470387,266	635,726	r
99	443875,206	4470387,519	635,389	r

100	443868,850	4470387,865	635,234	r
101	443862,187	4470388,204	634,908	r
102	443854,911	4470388,516	634,461	r
103	443855,064	4470382,315	634,193	r
104	443861,495	4470382,223	634,678	r
105	443868,004	4470382,118	635,071	r
106	443874,365	4470382,026	635,254	r
107	443880,773	4470381,849	635,457	r
108	443887,350	4470381,797	635,765	r
109	443893,468	4470381,579	636,209	r
110	443900,667	4470381,229	636,356	r
111	443901,099	4470374,175	635,966	r
112	443894,835	4470373,810	635,804	r
113	443888,004	4470373,905	635,558	r
114	443881,138	4470374,013	635,106	r
115	443874,336	4470374,063	634,804	r
116	443867,586	4470373,974	634,628	r
117	443861,220	4470373,988	634,298	r
118	443853,958	4470374,169	633,850	r
119	443854,110	4470368,172	633,678	r
120	443860,214	4470368,047	634,039	r
121	443866,619	4470367,831	634,279	r
122	443873,120	4470367,629	634,691	r
123	443880,277	4470367,750	634,925	r
124	443887,261	4470367,705	635,341	r
125	443893,887	4470367,804	635,404	r
126	443901,313	4470367,847	635,617	r
127	443900,688	4470361,349	635,369	r
128	443893,971	4470361,194	635,095	r
129	443886,882	4470360,874	634,946	r
130	443881,166	4470360,866	634,754	r
131	443874,610	4470360,696	634,305	r
132	443867,924	4470360,575	634,131	r
133	443861,848	4470360,556	633,835	r
134	443854,895	4470360,443	633,605	r
135	443854,689	4470354,013	633,398	r
136	443861,171	4470353,807	633,611	r
137	443867,903	4470353,903	633,690	r
138	443874,678	4470353,608	634,190	r

139	443881,232	4470353,606	634,403	r
140	443888,042	4470353,566	634,816	r
141	443894,733	4470353,492	634,940	r
142	443901,502	4470352,988	635,243	r
143	443901,236	4470346,092	635,052	r
144	443894,164	4470346,016	634,666	r
145	443886,464	4470345,819	634,401	r
146	443879,352	4470345,821	633,925	r
147	443872,052	4470345,815	633,583	r
148	443865,042	4470345,797	633,370	r
149	443858,404	4470346,063	633,281	r
150	443852,470	4470346,256	633,144	r
151	443852,020	4470339,469	633,077	r
152	443858,448	4470339,111	633,118	r
153	443865,419	4470338,813	633,254	r
154	443872,187	4470338,719	633,413	r
155	443883,105	4470338,251	634,101	r
156	443889,996	4470337,671	634,389	r
157	443896,392	4470337,218	634,548	r
158	443901,280	4470337,124	634,691	r
159	443901,342	4470331,003	634,663	r
160	443894,633	4470331,190	634,414	r
161	443888,160	4470331,460	634,024	r
162	443881,548	4470331,417	633,780	r
163	443873,276	4470331,332	633,314	r
164	443866,652	4470331,362	633,078	r
165	443860,934	4470331,473	633,019	r
166	443852,618	4470331,708	632,917	r
167	443851,948	4470326,692	632,989	r
168	443859,168	4470326,343	632,840	r
169	443866,579	4470326,187	633,055	r
170	443873,967	4470326,106	633,354	r
171	443882,511	4470325,965	633,703	r
172	443890,053	4470325,974	633,983	r
173	443896,765	4470325,857	634,269	r
174	443900,895	4470325,512	634,695	r
175	443848,562	4470337,137	632,991	m.4
176	443843,959	4470337,183	632,993	m.4
177	443849,157	4470346,051	629,743	m



178	443849,318	4470359,017	629,737	m
179	443847,403	4470353,888	632,664	viga met
180	443847,452	4470356,459	632,658	viga met
181	443847,501	4470359,042	632,649	viga met
182	443847,567	4470362,547	632,648	viga met
183	443847,617	4470365,162	632,656	viga met
184	443847,666	4470367,770	632,653	viga met
186	443845,216	4470386,817	631,168	m
187	443849,366	4470386,793	630,955	m
188	443849,637	4470386,282	630,901	m
189	443849,564	4470380,081	630,177	m
190	443849,518	4470374,607	629,967	m
191	443849,448	4470368,588	629,972	m
192	443849,395	4470365,854	629,731	m
193	443848,830	4470365,785	629,636	m
194	443848,830	4470359,183	628,557	m
195	443848,755	4470353,859	627,692	m
196	443848,713	4470349,690	627,058	rej .2
197	443848,611	4470341,094	627,024	m
198	443848,499	4470341,045	627,007	m
199	443848,482	4470340,220	626,996	rej
200	443847,659	4470338,093	627,040	m
201	443846,382	4470338,117	627,032	m
202	443845,287	4470340,271	626,967	rej gar
203	443845,349	4470345,004	627,013	p
204	443845,364	4470346,777	627,041	gar
205	443847,466	4470343,159	627,038	sn
206	443847,629	4470350,386	627,139	sn
207	443845,385	4470349,686	627,049	rej
208	443845,447	4470355,127	627,887	c
209	443845,511	4470361,135	628,860	c
210	443845,609	4470368,087	629,954	c 2.55
211	443844,543	4470373,070	629,938	c
212	443845,111	4470373,435	629,934	rej
213	443845,322	4470373,772	629,936	c
214	443845,669	4470374,641	629,958	c
215	443845,729	4470378,818	630,112	c
1000	443877,289	4470337,540	633,752	base
2000	443877,786	4470359,556	634,671	base

3000	443847,073	4470336,450	633,204	base
4000	443846,931	4470362,542	629,354	4000

17/02/2026 15:01:58	D:\Usuarios\Jesus\Documentos\Trimble Business Center\260217- Pablo Neruda 140-142 Madrid.vce	Trimble Business Center
---------------------	--	-------------------------



PLANO



C/ Cleopatra

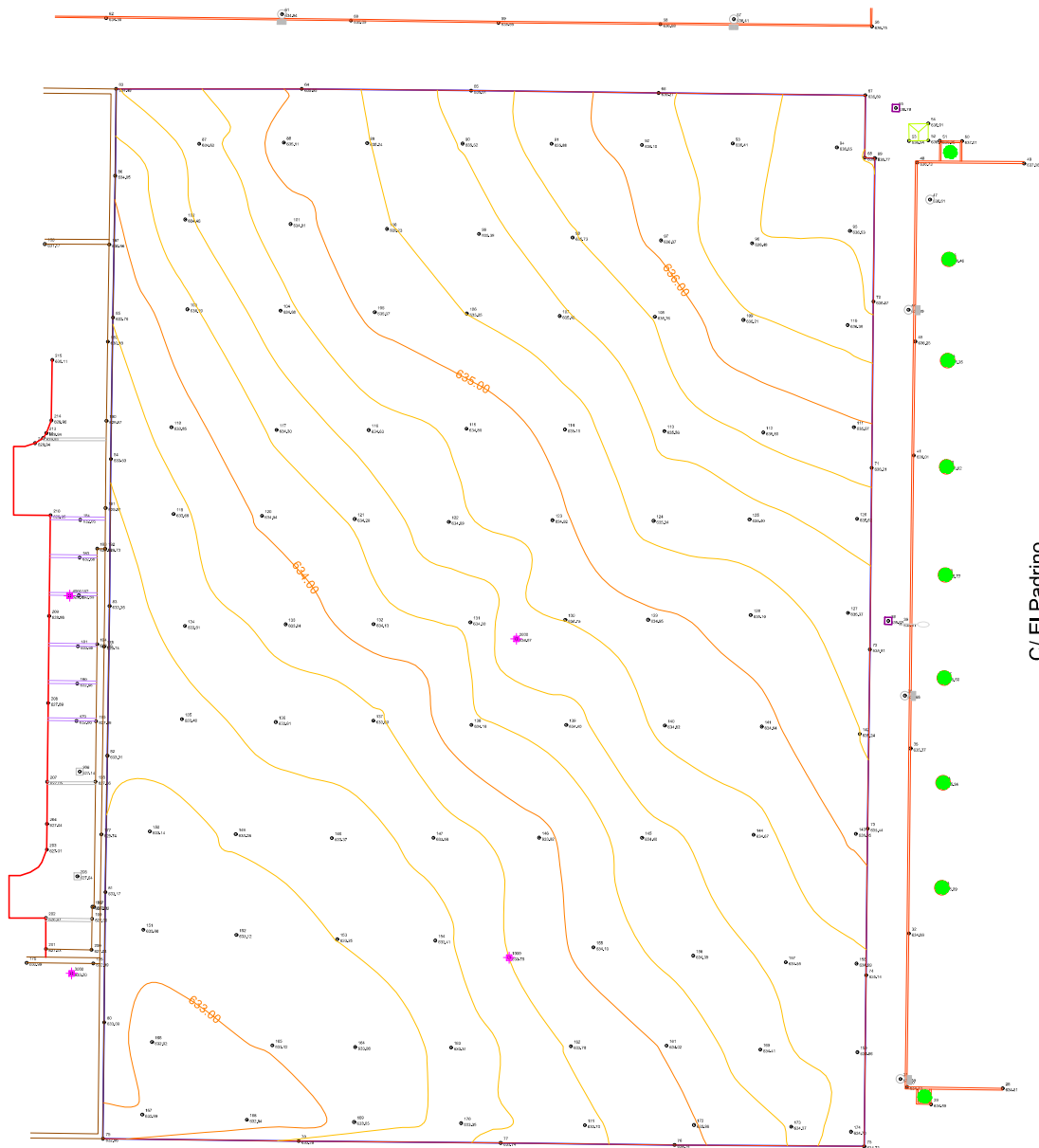

C/ Pablo Neruda

Superficie: 3.813,10 m2

SISTEMA DE REFERENCIA GEODÉSICO ETRS89  
PROYECCIÓN UTM. HUSO 30

0 10 20m

### Legenda

- Arbol.
- Base poligonal.
- Saneamiento.
- Farola.
- Registro alumbrado.
- Registro agua.
- Registro teléfono.
- Imbornal.
- Registro indefinido.
- Armario gas.
- Armario electricidad.
- Construcción.
- Muro.
- Curva directora.
- Curva de nivel.
- Bordillo.
- Perímetro parcela.

Datum: UTM-ETRS89 Imprimir A3



C/. Perú 8, oficina 43  
28290 Las Rozas  
Madrid  
Tel. 91 898 10 21  
Móvil 607 30 88 15  
topografia@geobrun.com

Ciente:  
Asamblea de Madrid

Realizado por:

FIRMA: Borja García J. Brún  
Ingeniero Técnico en Topografía

COLEGIADO: 8844

Situación:  
Av. Pablo Neruda nº140-140b  
28018 Madrid

Ref. catastral: 3905503VK4730F0001JH

Plano:  
Topográfico

Datum: UTM-ETRS89 30N

Imprimir A3

Num. Hoja:

1

Fecha:  
Feb-2026

Escala:  
1:350



**INGENIEROS CONSULTORES**  
**C/. PERU 8 28290 MADRID**  
**Tel. 918981021 - 607308815**  
**[topografia@geobrun.com](mailto:topografia@geobrun.com)**  
**[www.geobrun.com](http://www.geobrun.com)**